

JVC



## CATCH RESIDENCES

Emaar Properties | Apartment

 Jumeirah Village Circle

Life at Catch Residences is a unique combination of elegant urban flair, inspired by the sundrenched manner of the United States. Catch Residences, located in Jumeirah Village Circle, are a real catch.

They have a variety of 1-3 BR apartments available, as well as special launch waivers on land registration fees, payment options, and discounts. These apartments, offer a superb Miami lifestyle, replete with sun decks, stylish cabanas, pools with waterfalls, and more.

**From 250 000 USD**



**+971 58 610 0202**

Gym

Barbecue Garden

Swimming pool

Sun terrace

[towergroup.ae](https://towergroup.ae)



## LUMA 22

TOWNX | Q3 2024

 Jumeirah Village Circle

Centrally located in one of Dubai's most up-and-coming areas, Luma22 is an unparalleled building development. These ace apartments offer various sizes plus convenience, beauty and state-of-the-art amenities.

Discover your ideal living space in the exquisite, affordable upscale apartments of Luma22, with amenities designed for a community of busy professionals and families. Vibrant, light-filled spaces offer you a picturesque view of the centrally located private gardens.

**From 250 000 USD**



**+971 58 610 0202**

Gymnasium

Jacuzzi

Pets allowed

Swimming pool

[towergroup.ae](https://towergroup.ae)



## BINGHATTI CORNER

BINGHATTI | Q1 2024

 Jumeirah Village Circle

Nestled in the family-friendly area of Jumeirah Village Circle (JVC), Binghatti Corner is a mixed-use 29-storey project by the award-winning Binghatti Developers. The award-winning master developer has an investment value in excess of AED 3.5B (USD 952.8M) across an extensive portfolio of over 40 projects across some of the most iconic Dubai neighbourhoods.

In total, Binghatti Corner offers 634 residential units for purchase, namely stylish 1 and 2-bedroom apartments and 1-2 bedroom penthouses with a minimum area of 664 sq. ft. Not forgetting that prospective real estate investors have the opportunity to select from 69 offices and 14 retail spaces.

**From 250 000 USD**



**+971 58 610 0202**

Swimming Pool

Gym

Indoor Parking

CCTV

[towergroup.ae](http://towergroup.ae)

# BINGHATTI NOVA

Binghatti Developers | Q4 2023



New building Binghatti Nova in Dubai is a new premium residential complex from the well-known developer Binghatti. The eco-friendly project with stylish and spacious furnished apartments offers a full range of premium amenities surrounded by green landscaped gardens.

One of the advantages of the new complex is its location in the popular family area Jumeirah Village Circle. The community has its own autonomous infrastructure and has excellent transport accessibility. With nearby highways, future residents will have quick access to Dubai's key areas and attractions.

**From 250 000 USD**

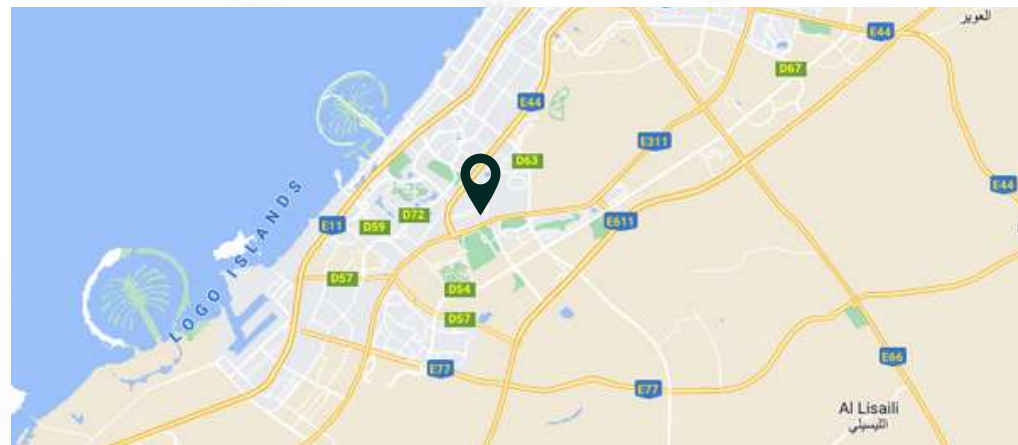

[towergroup.ae](http://towergroup.ae)



**+971 58 610 0202**

Open pool

Kid's Pool

Security 24/7

Barbeque Area

# ELITZ

Danube | Q4 2025



Here comes the latest launch, Elitz by Danube Properties that offers luxury studios, 1, 2 & 3 bedroom apartments and 4 bedroom penthouses at JVC, Dubai. This new residential development presents extra flavours of life and health combined to enhance the moments with lovely views of nature and a surrounding to attract everyone.

The location is magnificent in terms of its proximity and access, bringing well-known destinations, business and commercial hubs, restaurants, spas, and gyms, as well as other places that fulfil lifestyle expectations, in a matter of minutes. It has the best amenities and services available.

**From 250 000 USD**



[towergroup.ae](http://towergroup.ae)



# Elitz

**DANUBE**

The New Icon Awaits



**+971 58 610 0202**

Swimming Pool

Gymnasium

Jogging Track

Retail Outlets

# BINGHATTI CRESCENT

Binghatti Developers | Q4 2023



The residential complex from the famous Binghatti Developers offers luxurious options for apartments with 1, 2 and 3 bedrooms.

Low-rise 5-story architecture mixed with retail and the developer's signature color tone. Exclusive class development allows residents to experience entertainment and attractions right outside the door.

**From 250 000 USD**



[towergroup.ae](http://towergroup.ae)



**+971 58 610 0202**

Swimming pool

Gym

Community View

Terrace

# THE PORTMAN

Ellington Properties | Q1 2025

 Jumeirah Village Circle

The Portman is the newest addition by Ellington Properties to the sought-after area of Jumeirah Village Circle. It comes as an elegant 16-storey tower with a total of 173 units, namely sophisticated studios and 1-2 bedroom apartments.

The envisioned building will boast a contrasting palette of white and timber, along with grand lobby windows and an entrance with dark travertine finishes.

**From 250 000 USD**

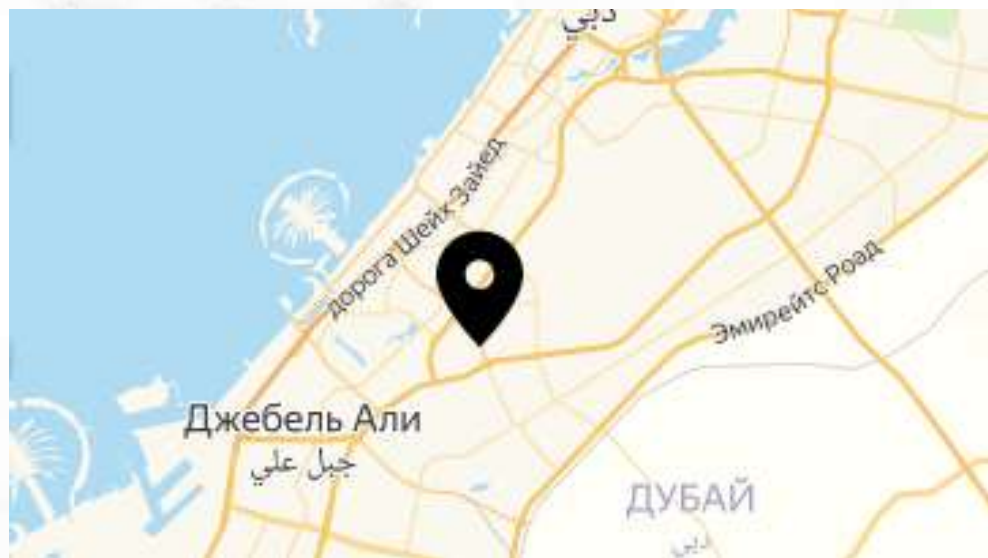

[towergroup.ae](http://towergroup.ae)

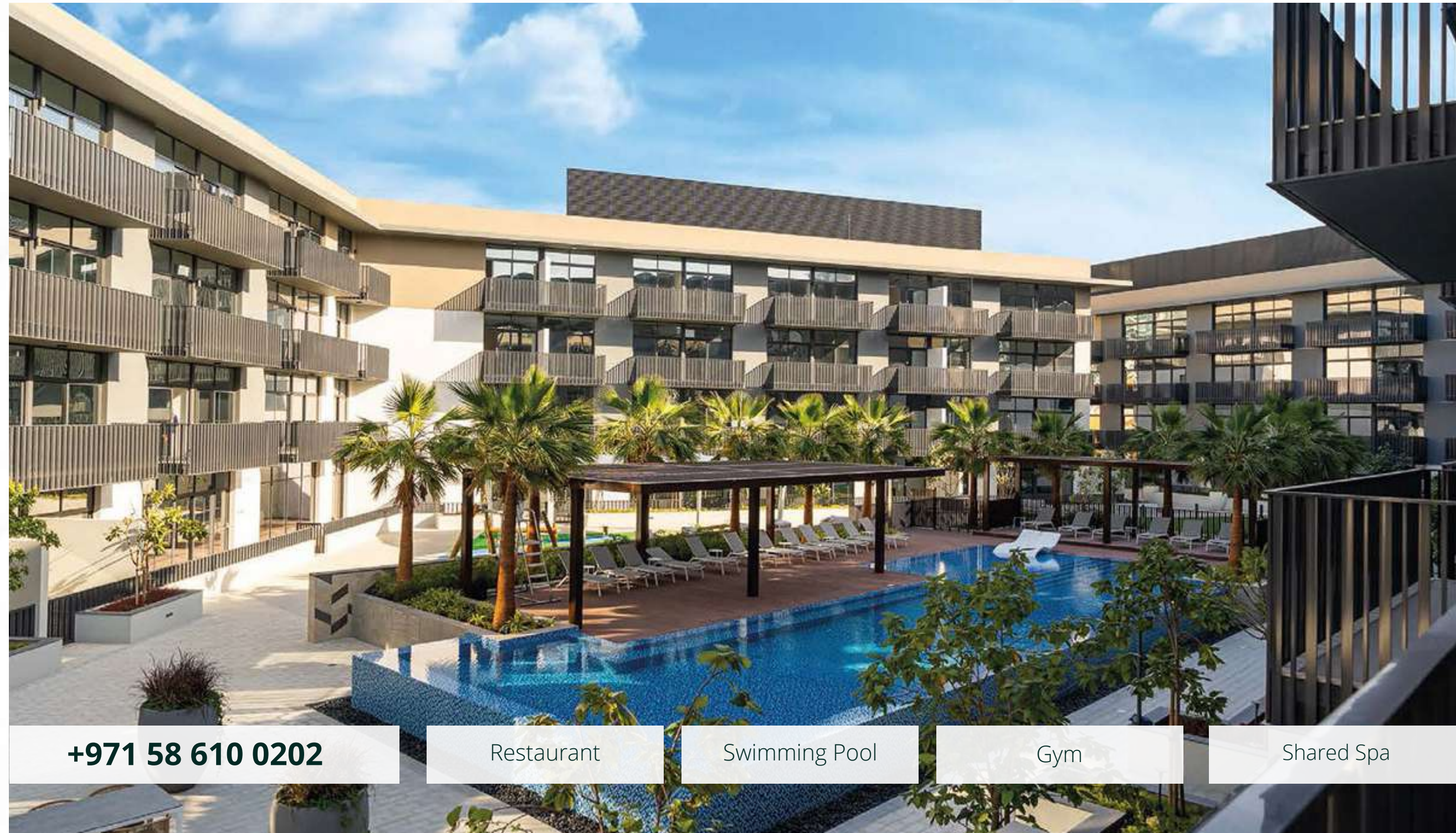

**+971 58 610 0202**

Restaurant

Swimming Pool

Gym

Shared Spa



# THE CLOUD TOWER

Tiger Group | Q1 2025

 Jumeirah Village Circle



Presenting, The Cloud Tower at Jumeirah Village Triangle (JVT), new residential buildings by Tiger Properties are the home to a wide mix of modern apartments in Dubai, UAE. Comprising of two high-rise towers, the development is aimed towards looking for sophisticated and premium homes at an affordable range.

The development with multiple stories will further offer inspiring views of the surrounding areas. Besides, for the larger benefit of the future residents, the amenities and facilities to be made available will be one of a kind.

**From 250 000 USD**

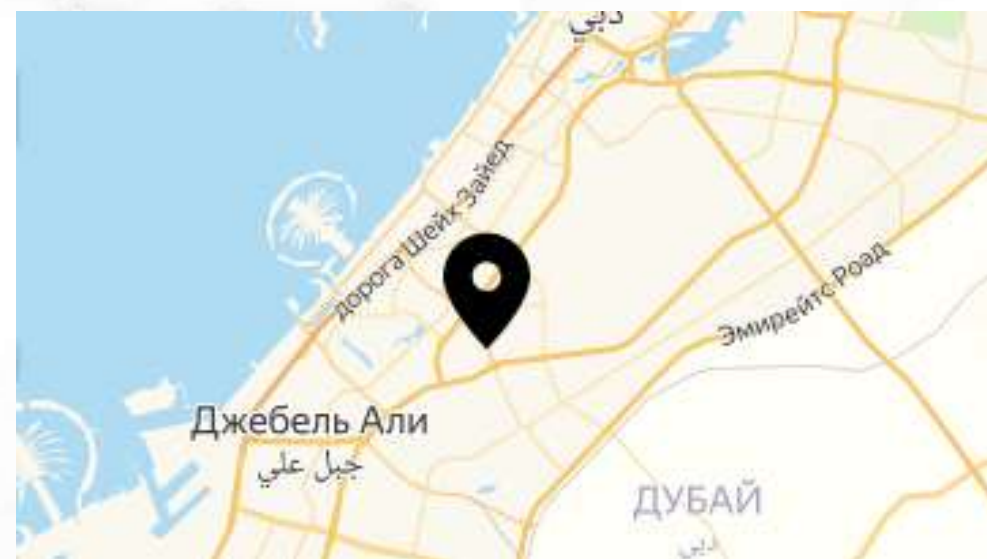

[towergroup.ae](http://towergroup.ae)

**+971 58 610 0202**

Gymnasium

Swimming Pool

Jogging Track

Barbeque Area



[towergroup.ae](http://towergroup.ae)