

ELLINGTON

BELMONT RESIDENCE

Ellington Group | Q4 2024



Introducing Belmont Residences at Jumeirah Village Triangle by Ellington Properties that offers studios, 1 & 2 bedroom apartments within Dubai. It's a fully enhanced and equipped development with premium amenities, aesthetic designs, artistic decor and brilliant connectivity.

Experience a lifestyle inspired by the metropolitan city of London within this five-storey residential façade that caters for your every need.

From 166 500 USD



towergroup.ae

+971 58 610 0202

Pool Sun Lounger

Basketball Court

Tennis Court

Community Parks

THE PORTMAN

Ellington Properties | Q1 2025

 Jumeirah Village Circle

The Portman is the newest addition by Ellington Properties to the sought-after area of Jumeirah Village Circle. It comes as an elegant 16-storey tower with a total of 173 units, namely sophisticated studios and 1-2 bedroom apartments.

The envisioned building will boast a contrasting palette of white and timber, along with grand lobby windows and an entrance with dark travertine finishes.

From 226 000 USD

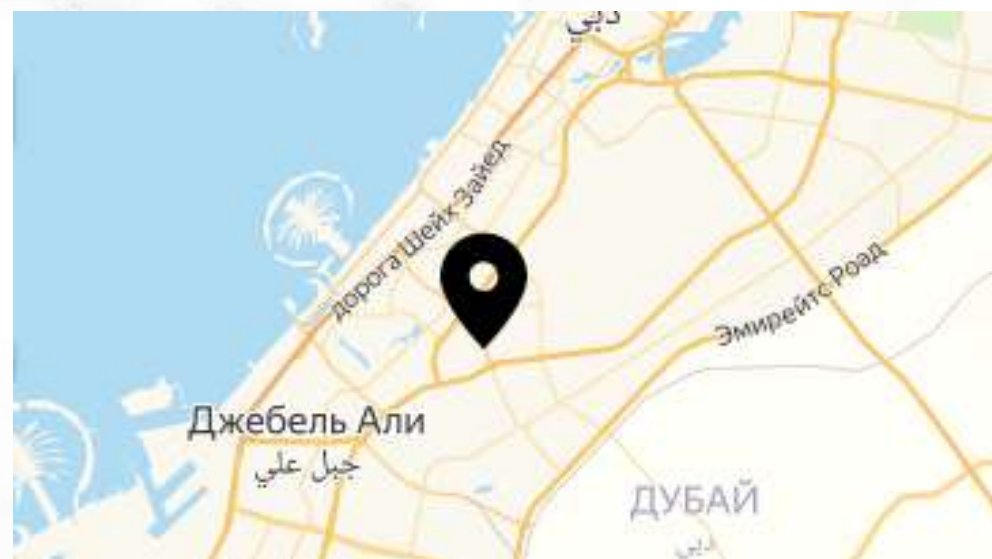

towergroup.ae

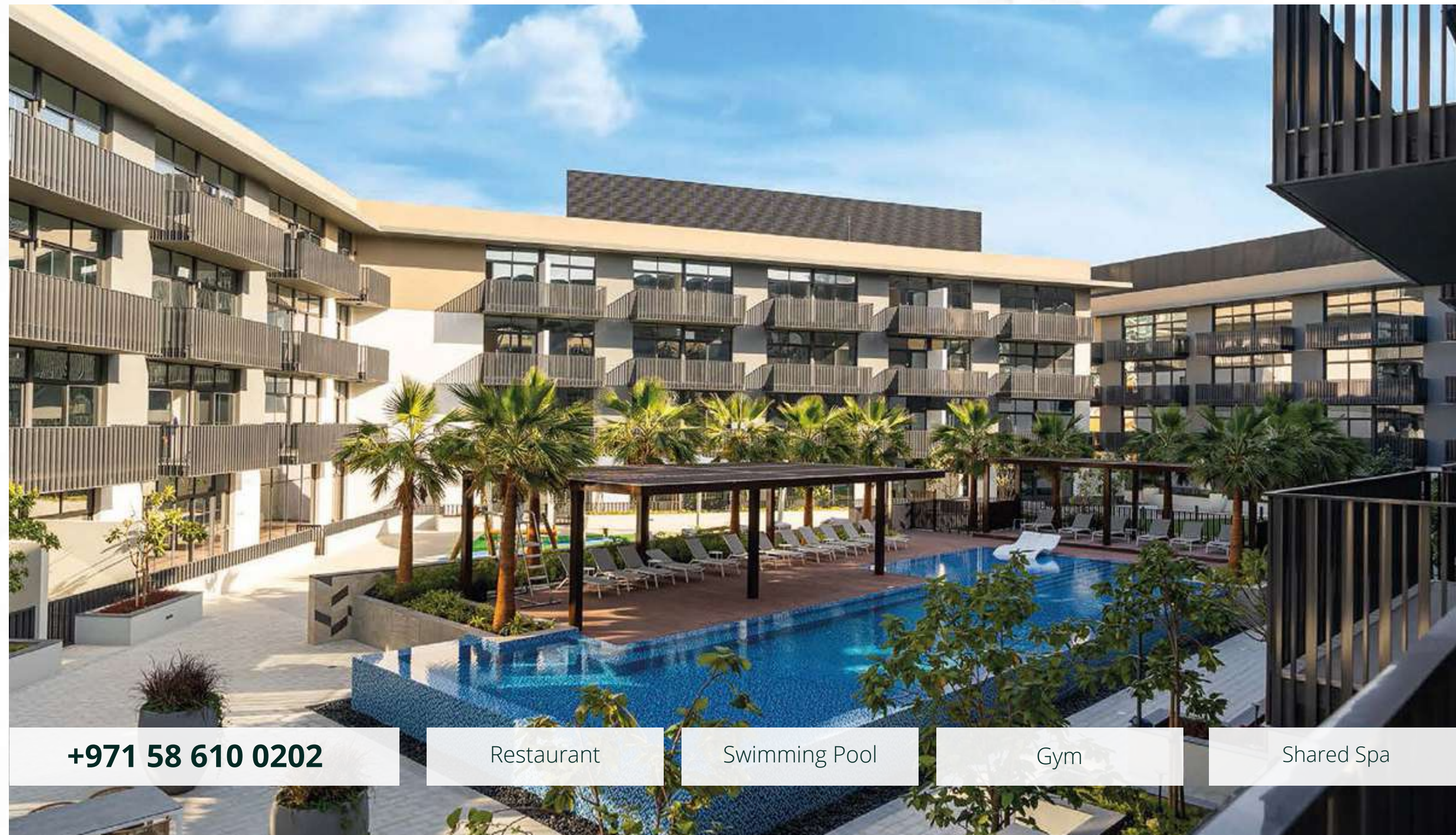

+971 58 610 0202

Restaurant

Swimming Pool

Gym

Shared Spa



ELLINGTON HOUSE

Ellington Properties | Q1 2025

 Dubai Hills Estate

Ellington House at Dubai Hills Estate is a new residential project that features luxury 1, 2 & 3 bedroom apartments, lined with extensive amenities. The 12-storey façade is presented by Ellington Properties, where you will surely experience an exclusive lifestyle.

Among the attraction, the development welcomes you with its grand lobby entrance offering understated elegance design, high floor to ceiling windows and the lush outside views. The soft colour palette of the lobby matches the warm and inviting setting with the mezzanine level lounge area, accessed by an angled stairway that's flanked by the stunning library wall.

From 456 000 USD

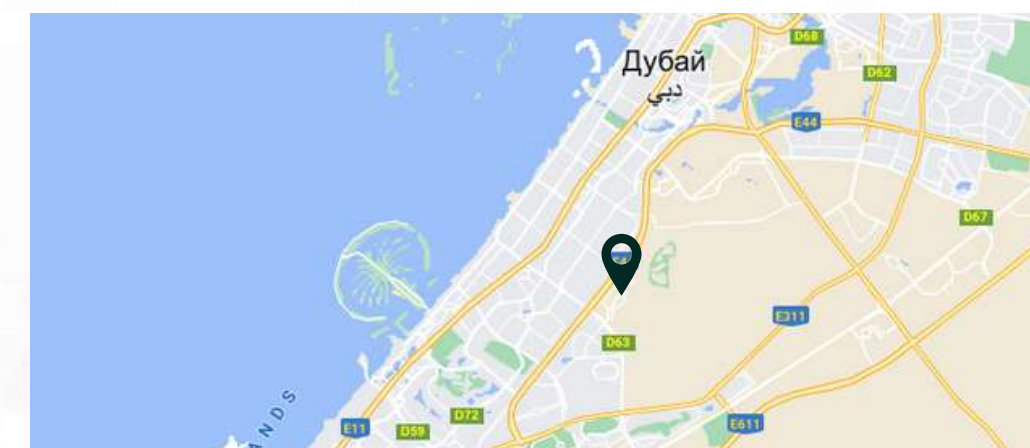

+971 58 610 0202

Gym

Swimming Pool

24/7 Security

Cycling Track

towergroup.ae

ELLINGTON BEACH HOUSE

Ellington Properties | Q2 2024

 The Palm Jumeirah



Launched in Q2 2022, Ellington Beach House is the first residential building by Ellington Properties in the ultra-prestigious area of Palm Jumeirah.

This boutique 7-storey development features a selection of exclusive 1-3 bedroom apartments and opulent penthouses with beautifully crafted interiors. The living area of apartments ranges from 1,000 sq. ft to 2,000 sq. ft and there are a total of 123 sophisticated residences available for purchase.

From 1 895 000 USD



towergroup.ae



+971 54 539 0810

Private beach

Swimming pools

Clubhouse

Bespoke spa center

OCEAN HOUSE

Ellington Group | Q4 2025

 Palm Jumeirah

Situated on the ever popular Palm Jumeirah, Ocean House is an ultra-luxury 9-storey complex by Ellington Properties, with a bespoke collection of 88 designer units. This is the third and the final project by the boutique real estate company on the palm-shaped island, and is being developed in partnership with SOL Properties, which is a real estate arm of Bhatia Group, as well as the world's third best architectural company; Northacre – a subsidiary of Dubai-based SHUAA Capital.

The elite development will feature a collection of extravagant 2-bedroom single and dual aspect apartments, 3-4 bedroom dual aspect residences and 2-4 bedroom duplexes with floor plan spaces from 1,642 sq. ft to 9,917 sq. ft.

From 2 528 000 USD



towergroup.ae



+971 58 610 0202

Swimming Pool

Gymnasium

24/7 Security

Cycling Track



towergroup.ae